

Positioned in Spencer Dock on the banks of the River Liffey and due to open in September 2010, The Convention Centre Dublin is Ireland's new world-class, purpose-built international conference and event venue.

The venue comprises two exhibition halls and a theatre and provides an exceptional venue for both national and international conferences and corporate events. The Centre's iconic status combines spacious, flexible and elegant conference halls and leading-edge technology with expert management and an extensive range of support services.

For the Exhibition Halls, Unusual designed, manufactured and installed:

- 132 chain hoists, split 80/52 between the two exhibition halls, supporting 32 truss lighting grids with positional and group control

For the Theatre, Unusual designed, manufactured and installed:

- Counterweight flying system comprising 54 sets
- Travelling beam system for chain hoist secondary suspension
- Fire curtain 22m x 11m
- Motorised house curtain
- Proscenium masking
- Dual orchestra pit elevator system
- Modular orchestra pit rail
- Modular trappable stage
- Loudspeaker hoists

Client: CMP/SISK
Scope: Full stage engineering fit-out
View at: www.theccd.ie



View from fly tower with fly bars at stage level

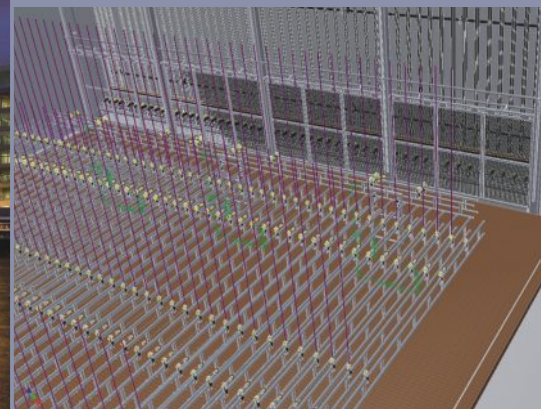

General view of grid and head blocks

